

Owner: BUXTON CEMETERY
Co-Owner:
Mailing Address: UNK
N SMITHFIELD RI 02896

Assessment: Total: \$47,700
Total Building: \$0, Land: \$47,700, Yard Items: \$0

Land Information
Land Area: 18,460 Primary Zoning: RS
Land Use: Cemetery
Neighborhood: 0050

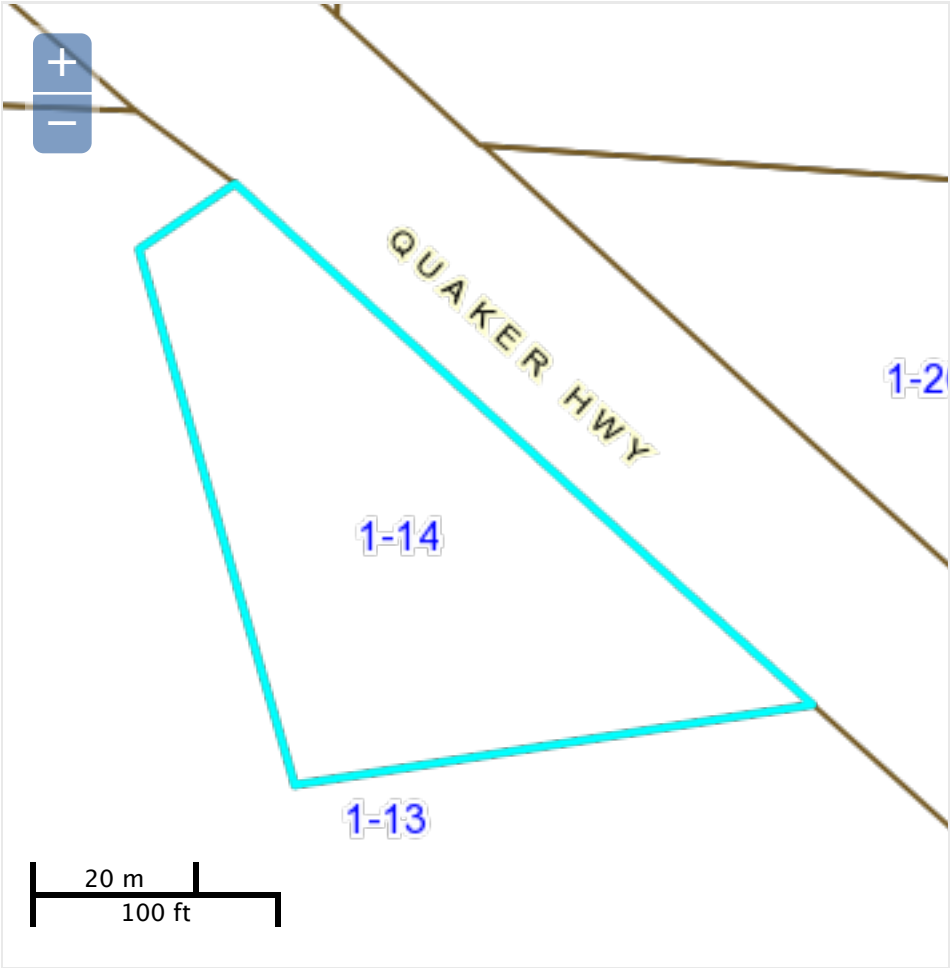
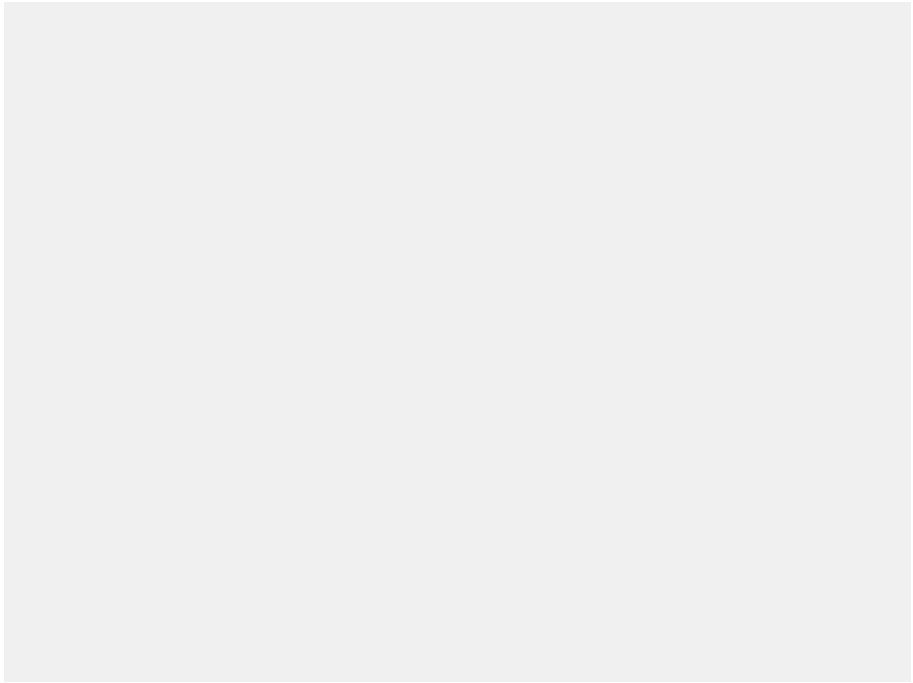

Building Information

Year Built:
Style:
Rooms:
Bedrooms:
Full Baths: 0
Half Baths: 0
Gross Area: 0
Finished Area: 0

Stories:
Heat Fuel:
Heat Type:
Frame:
Exterior:
Roof Structure:
Roof Covering:
Kitchens: 0
Fireplaces: 0

Sales History

Grantor

<u>Legal Reference</u>	<u>Sale Date</u>	<u>Sale Price</u>
2219CONV	1900/1/1	\$0
102208CONV	1900/1/1	\$0
90551CONV	1900/1/1	\$0
24345CONV	1900/1/1	\$0
74892CONV	1900/1/1	\$0



MainStreetGIS, LLC
www.mainstreetgis.com