



North Smithfield, RI



Disclaimer: This information is for tax assessing purposes and is not warranted

Parcel Identification		Assessment	
Map/Lot	001-014	Land	\$47,700
Account	4465	Building	\$0
State Code	70 - Cemetery	Card Total	\$47,700
Card	1/1	Parcel Total	\$47,700
User Account	39-0005-00		

Prior Assessments

Fiscal Year	Land Value	Building Value	Outbuilding Value	Total Value
2020	\$47,700	\$0	\$0	\$47,700
2019	\$47,700	\$0	\$0	\$47,700
2018	\$53,400	\$0	\$0	\$53,400
2017	\$53,400	\$0	\$0	\$53,400

Location and Owner

Location	0 QUAKER HWY
Owner	BUXTON CEMETERY
Owner2	
Owner3	
Address	UNK
Address2	
Address3	N SMITHFIELD RI 02896

Building Information

Design	
Year Built	
Heat	
Fireplaces	0
Rooms	0
Bedrooms	0
Bathrooms	
Above Grade Living Area	0 SF

Sale Information

Sale Date	Sale Price	Legal Reference	Instrument
01/01/1900	\$0	2219CONV	

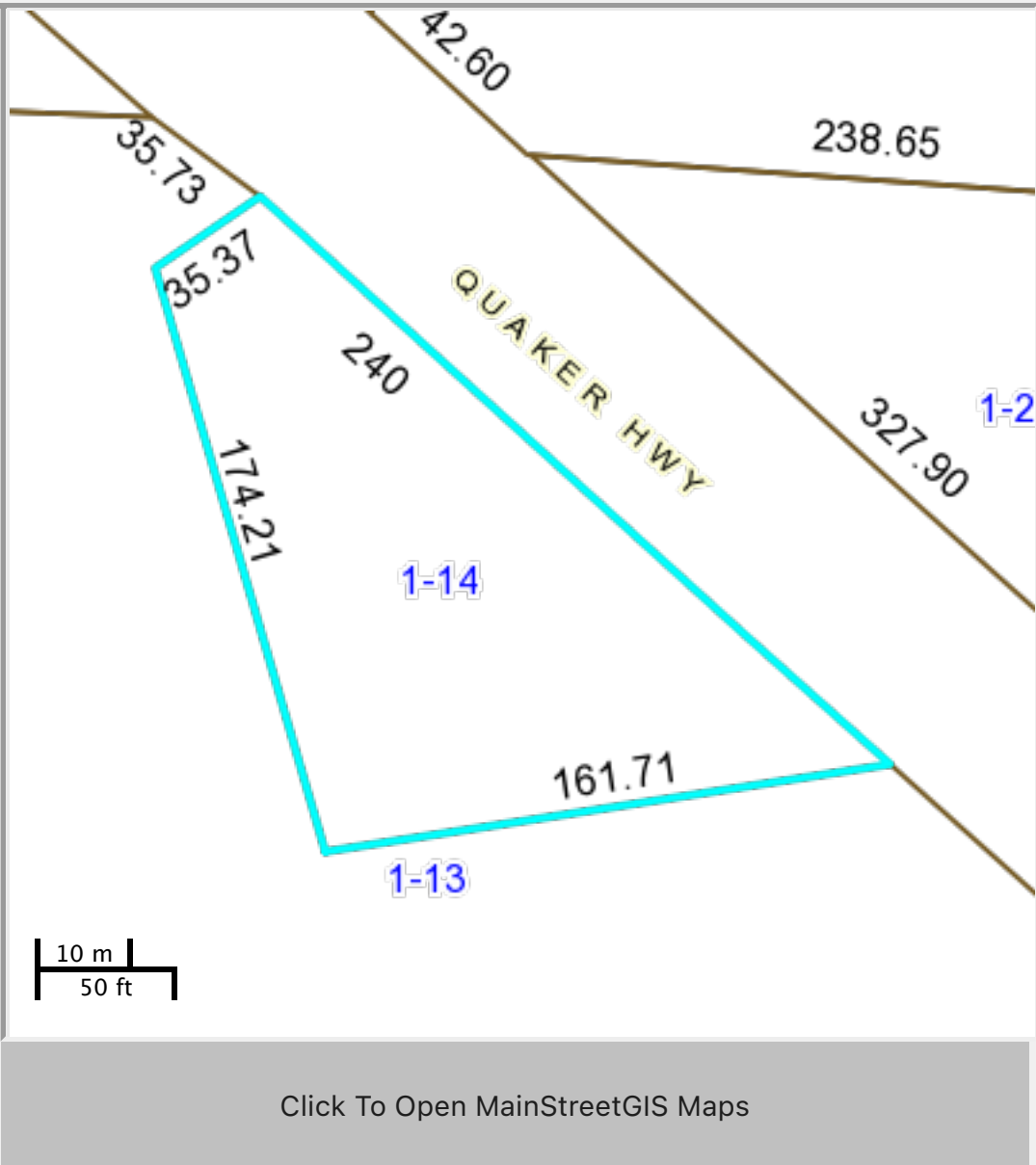

Picture Not Available



Sketch Not Available



Building Sub Areas

Land Information

Land Area	0.424 AC
Zoning	RS
View	-
Neighborhood	0050

Yard Item(s)